

Portable Air Filtration Systems

Instruction Manual
Models 1500 & 3000

**Read and
keep this manual for
reference purposes**

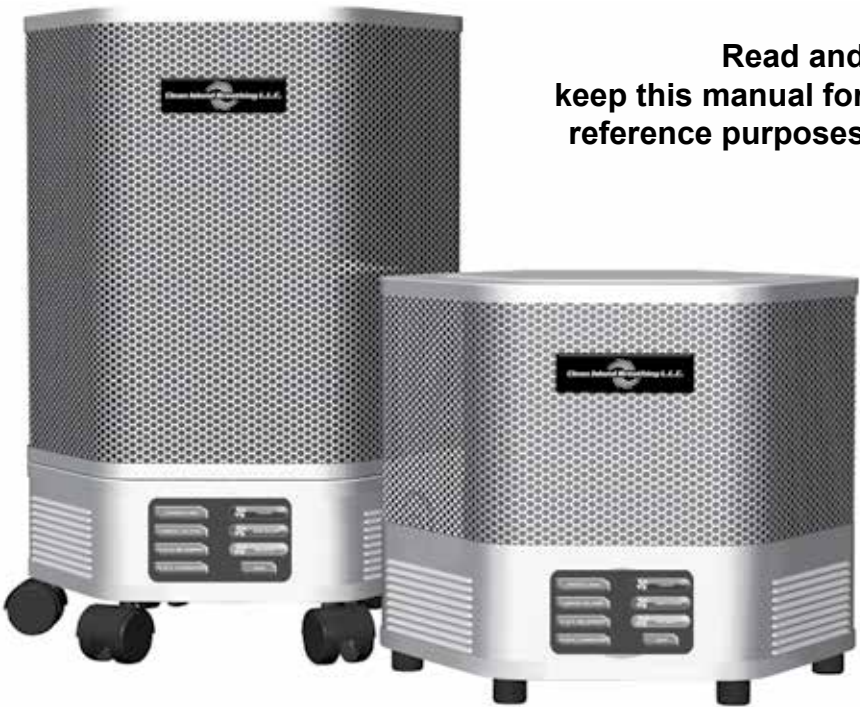

Thank you for purchasing a Clean Island Breathing portable air filtration system. With proper care and maintenance, your Clean Island Breathing system will provide many years of reliable service, improving the quality of your air.

ABOUT FILTERS AND SERVICE LIFE

The life spans of the individual filters are:

STAGE 1 PREFILTER: 3 to 6 months

STAGE 2 HEPA FILTER: 2 to 5 years

STAGE 3 V.O.C. BLANKET: 6 to 8 months

OPTIONAL V.O.C. CANISTER: 6 to 12 months

The useful service life of the filters is directly related to the volume of air passed through the system and the amount of contaminants in the air. If your indoor air contains abnormally high levels of airborne contaminants (such as cigarette smoke) the life of the filters may be shortened. The HEPA filter's particulate removal efficiency actually improves with use as it loads up with particulates. However, as it loads up it also becomes more difficult to move air through the system. If you notice a significant drop in air flow from the unit, the HEPA filter should be replaced.

THREE-STAGE FILTRATION

STAGE 1: Prefilter

Removes large particulates and odors. Extends the life of the HEPA filter.

STAGE 2: HEPA Filter

99.97% efficient @ 0.3 microns. Removes dust, pollen, bacteria, animal dander, attached viruses, cigarette smoke, radon daughters and more.

STAGE 3: V.O.C. Blanket

Removes odors and hazardous chemicals that may off-gas from cleaners, paints, solvents, carpets, furniture and other items containing synthetic materials.

OPTIONAL V.O.C. Canister

For heavy-duty removal of gases and odors.



Specifications (all models)

CLASSIFICATION

- Portable HEPA (High Efficiency Particulate Air)
100% Sealed Air Cleaning Device
- C.S.A. approved

MATERIALS: 24 gauge cold rolled steel

FINISH: Powder coated baked enamel

COLOR: Sandstone

INTAKE (Upper Section)

Perforated steel enclosure surrounding a three-stage filter assembly.

OUTFLOW (Lower Section)

Encloses motor/fan.

MOTOR/FAN

- Thermally protected Class "B" insulated motor
- Designed for continuous operation
- Run tested for 50,000 hours
- Service: 120 Volt, 60 Hz.

CONTROL: 3 Speed Electronic Control

Model 1500

DIMENSIONS: 16" W, 13.5"H

WEIGHT: 15 lbs.

AIR FLOW (C.F.M.): 50-175

POWER USAGE: 41-84 Watts



Model 3000

DIMENSIONS: 16" W 23"H

WEIGHT: 22 lbs.

AIR FLOW (C.F.M.): 50-225

POWER USAGE: 41-84 Watts





REPLACEMENT PARTS

Item	Item Number
1500	US
Replacement HEPA Cartridge - 8" ET	90012206
Annual Filter Kit: Standard - 8" ET	94012011
Annual Filter Kit: Plus - 8" ET	94012231
Motor	99011150
3000	
Replacement HEPA Cartridge - 16" ET	90015406
Annual Filter Kit: Standard - 16" ET	94015011
Annual Filter Kit: Plus - 16" ET	94015231
Motor	99011150

Clean Island Breathing L.L.C.

Questions? Comments? Email us at: info@cleanislandbreathing.com
P.O. Box 10271, Lahaina, HI 96761

Clean Island Breathing reserves the right to change or modify any specifications without notice.

Visit our website at: www.cleanislandbreathing.com

MAINTENANCE: FILTER REPLACEMENT INSTRUCTIONS

When a red LED filter light is flashing...

Opening the cabinet

1. Turn the unit off and unplug it.
2. Unscrew the 5 lid screws. Once all five screws are out, remove the metal cover.
3. Bracing the unit so it does not move, turn the HEPA cartridge counter-clockwise and lift/pull out.

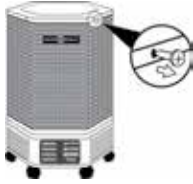

Pre-filter

1. Pull the pre-filter up and off the unit.

NOTE: The pre-filter may contain contaminants, remove it slowly to avoid releasing particles back into the air.

2. Foam pre-filters can be washed several times, wash by hand in warm water. Let it dry completely before placing it back onto the HEPA cartridge.
3. If replacing the filter, remove plastic shrink wrap from the new pre-filter.
4. Stretch the new/washed filter around the top of the HEPA cartridge and slide it down into place

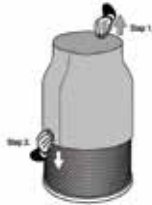

HEPA filter

1. Place the HEPA cartridge gently into the unit.
2. When the HEPA cartridge is in place, brace the unit, press down and gently turn it clockwise to lock it into place. If too much force is used, the cartridge may be difficult to remove!
3. If replacing the HEPA filter with a new filter, discard old HEPA filter and use new when replacing the HEPA filter into the unit.
4. With each annual filter replacement kit, a new 'o' ring is provided. The old one is removed by pinching it between two fingers and pulling it off the collar on the blower deck.
5. Discard old 'o' ring.
6. Place the new 'o' ring onto the collar and slide it down to the base of the blower deck.

Inner Carbon Filter Replacement

1. Look inside the HEPA cartridge to locate the two ends of the inner carbon filter.
2. Pull one end of the old inner carbon filter

HEPA Filter Replacement

As the HEPA filter captures particulates, it will darken over time. Replace the HEPA filter when it darkens to example D.

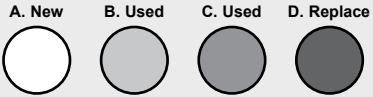

in and bend it into a loose roll so it can be removed.

3. Remove the inner carbon filter from the HEPA cartridge.
4. Remove plastic shrink wrap from the new inner carbon filter.
5. Unroll the inner carbon filter and roll it up in the opposite direction (this makes the filter follow a more contoured profile against the inner HEPA filter surfaces and helps keep it in place), place the rolled inner carbon filter inside the HEPA cartridge and gently unroll it until the ends 'butt' together and the filter is snug against the HEPA filter.

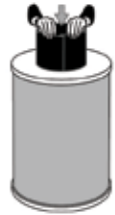

V.O.C. Canister (OPTIONAL)

1. Remove old Carbon Filter by pulling it out from the inside of the HEPA filter.
2. Remove the plastic shrink wrap from the new carbon canister.
3. Place the carbon canister inside the Air Filtration System, smaller end first.
4. Slide the HEPA Filter over the V.O.C. Canister and down into the Air Filtration System.
5. Gently, turn the HEPA Filter until it locks into place.

Closing the cabinet

1. Position the top cover on the unit with the centered screw hole at the rear of the unit.
2. To replace the lid screws, apply firm pressure to the top cover to align the holes and then insert and fasten screws.
3. Plug the unit in and turn it on.

OPERATING YOUR CLEAN ISLAND BREATHING HEPA AIR FILTRATION SYSTEM

OPERATION

1. Place the unit in the area where you want the cleanest air.
2. Plug the electrical cord provided into a compatible grounded outlet.
3. To operate, select the desired speed by pressing firmly on one of the buttons marked "HIGH", "MEDIUM" or "SILENT". The appropriate green LED light will illuminate and 3 red LED lights will indicate active stage filtration.
4. To stop the unit operation, press firmly on the button marked "OFF".

FILTER LIGHT INDICATORS

Your HEPA system is equipped with an electronic filter timer. This timer monitors the life expectancy of each filter in the unit. By default, the Pre-Filter, HEPA Filter and V.O.C. Blanket lights will turn on when the unit is powered on.

If you have upgraded your V.O.C. Blanket to a V.O.C. Canister, you must activate the corresponding timer.

- Press and hold the V.O.C. Canister button until the light comes on. The V.O.C. Blanket light will automatically go off. The control panel will now monitor the life expectancy of the V.O.C. Canister.

If you are switching your V.O.C. Canister to a V.O.C. Blanket, you must activate the corresponding timer.

- Press and hold the V.O.C. Blanket button until the light comes on. The V.O.C. Canister light will automatically go off.
The control panel will now monitor the life expectancy of the V.O.C. Blanket.

When a filter indicator light flashes, it is time to check and replace that filter.

- Turn the unit off and see instructions for "filter removal" to determine if filter replacement is needed. See 'Maintenance' on next page.
Once the filters have been checked or replaced, turn the unit back on and reset the control panel.
- To reset, press and hold the flashing filter button until the light is constant.

CAUTION

1. Make sure the cord is not in the path of people walking or where anything can be rolled over it.
2. Do not place any objects on top of the unit or allow anyone to sit on it.
3. NEVER place any liquids or plants on the unit. Moisture could leak into the unit and damage the filter media or electrical components.
4. The air filtration system discharges the cleaned air through the vents near the bottom on four of the six sides. On "HIGH" the velocity of the air coming out is high to enhance circulation throughout the area being cleaned. If the airflow is bothersome or creates a draft, turn the unit until the air is directed toward an unoccupied area of the room.

CLEAN ISLAND BREATHING LIMITED WARRANTY

Clean Island Breathing L.L.C. warrants **Clean Island Breathing** HEPA Air Filtration Systems to the original retail purchaser as follows:

1. The motor/fan part is warranted for five (5) years from the date of purchase under the following conditions:
2. All other component parts (except filters) are warranted for one (1) year from the date of purchase under the following conditions:
 - i. The Clean Island Breathing HEPA Air Filtration System has failed under normal use, due to defects in material or workmanship.
 - ii. The Clean Island Breathing HEPA Air Filtration System has been operated according to the manufacturers recommendations.
 - iii. The Clean Island Breathing HEPA Air Filtration System has been operated in compliance with the voltages specified on the product.
 - iv. An authorized Clean Island Breathing dealer or a service provider agreed upon by both the consumer and the manufacturer has performed an inspection.
 - v. There have been no attempts to modify the Clean Island Breathing HEPA Air Filtration System from its original condition.

Actions contrary to the above will void the Clean Island Breathing warranty.

Clean Island Breathing HEPA Air Filtration Systems that have qualified for warranty and met all of the above conditions will, at the discretion of the manufacturer, have the failing components repaired or replaced or, at the option of the manufacturer, be replaced with a new system.

MAKING A WARRANTY CLAIM

The consumer may make a warranty claim by contacting the any authorized Clean Island Breathing dealer. The dealer will then contact the manufacturer, Clean Island Breathing L.L.C., to obtain a Repair Return Authorization.

If the consumer is unable to contact an authorized dealer in their area, they should directly contact the manufacturer, Clean Island Breathing L.L.C., at 1 808 298 9771 or info@cleanislandbreathing.com to obtain a Repair Return Authorization.

To obtain a Repair Return Authorization, a valid serial number and/or original proof of purchase must be presented to the manufacturer.

RETURNING THE SYSTEM FOR WARRANTY INSPECTION AND/OR REPAIR

Prior to returning any product for warranty repair, the consumer must remove all filter components.

In the interest of consumer and employee safety, Clean Island Breathing L.L.C. will not receive any filter media that has left the manufacturers premises. Any Systems returned for inspection and/or repair with the filters included will not be received by Clean Island Breathing L.L.C. and will be returned to the consumer/dealer at the consumer/dealer's expense.

Excluding the filters, the consumer is required to return all original product components, including adaptors if applicable.